

SPECIFICATION:

Contact Rating : TV-5() 10A250VAC
 : 5A/80A 250V~uT85()
 Initial Contact Resistance: 50 Milliohms Max.
 Insulation Resistance : 500 Megohms Min. 500VDC
 Withstand Voltage : 2,000VAC-1 Minute
 Life Expectancy : Over 10,000 Cycles
 Operating Force : 600±200gf
 Contact : momentary
 RoHS Compline

UL FILE NO : E105856
 CSA FILE NO : LR67824-17
 VDE FILE NO : 40080883
 DEMKO FILE NO : 115164
 SEMIKO FILE NO : 9418052
 NEMIKO FILE NO : L93406
 FI FILE NO : 195588-01

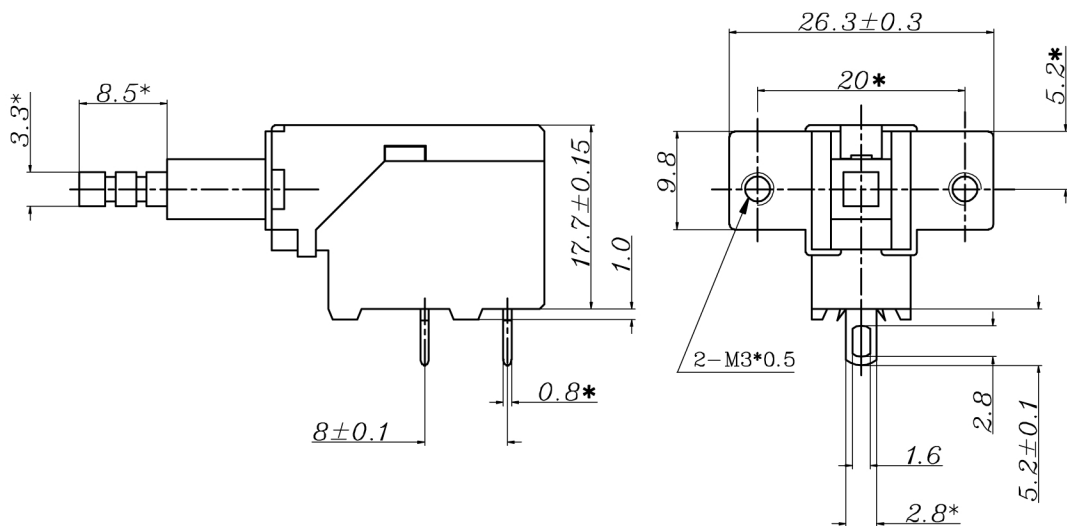

MODEL NO	SCHEMATIC
P12-21	

主要尺寸 (*)		重要尺寸	
A1	8.5*	A	27.5±0.3
B1	0.8*	B	17.5±0.2
C1	20*	C	11.6±0.15
D1	5.2*	D	17.7±0.15
E1	2.8*	E	8±0.1
F1	3.3*	F	26.3±0.3
G1		G	5.2±0.1
H1		H	
I1		I	
J1		J	

						DES	P12 SERIES
TOL	>0.3	±0.1	DRW	Z, H, R	2006.09.14	TITLE	PUSH SWITCH
	>6	± 0.15	DESIGN	Z, H, R	2006.09.14	DWG NO.	PNA-000811
	>30	±0.3	CHECKED			MODEL	5030
SCALE		UNIT	mm	APPROVED		VERSION	A1
PROJ		TOTAL	1	PAGE	1 OF 1	DATE	